

Monteringsanvisning • Erection Instructions •
 Aufbauanleitung • Opbouw instructie •
 Instruction de Montage • Instrucciones de montaje

 **"SELECT" 1997**
Scabella

Made in Denmark by Jydsk Camping Industri A/S DK 7100 Vejle

Pat. Pend
HERCULES
 Twin

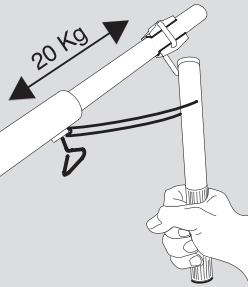

20 Kg

Opspænding
 Uppspänning
 Tensioning
 Abspannung
 Afspänning
 Tensión
 Tension

AKP • Vejle, d. 26/10/95 (25/07/96)

Ekstraudstyr
 Optional extra
 Sonderausrüstung
 Accesorio opcional
 Accessoire en option

No. 60126
 Twin

No. 60101
 FixOn

FixOn

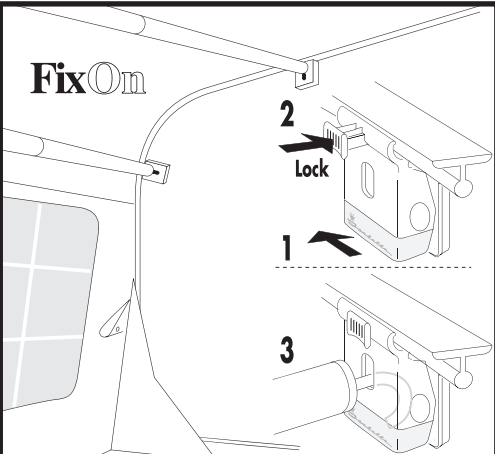

2
 Lock

1

3

1

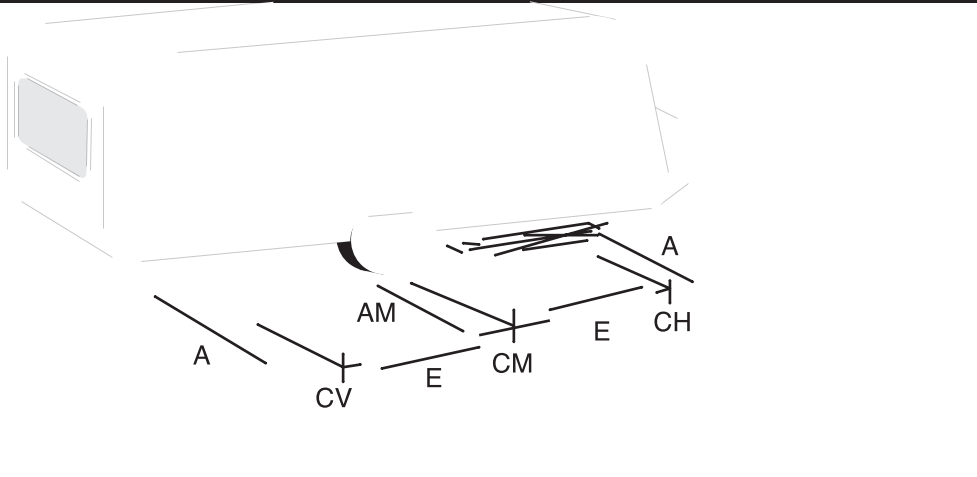

2

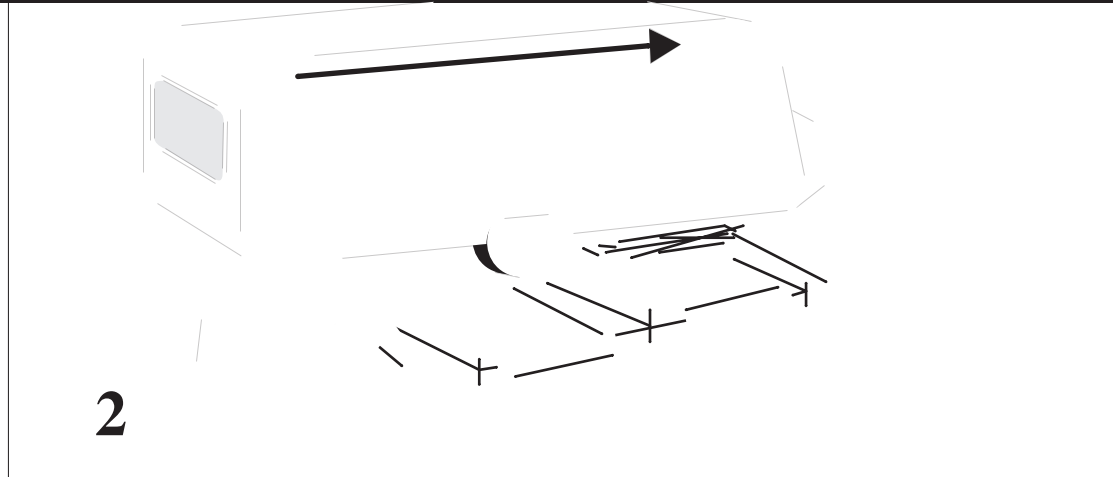

3

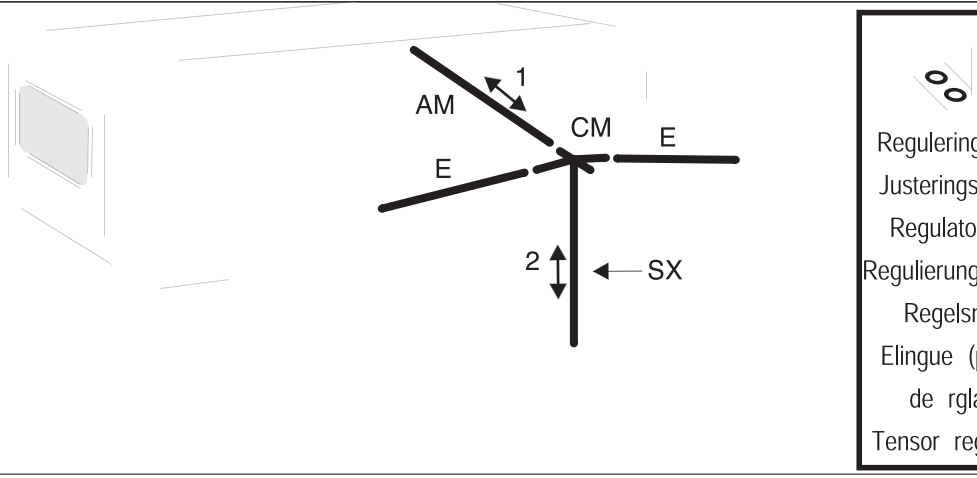

0 0

Reguleringsstrop
 Justeringsstropp
 Regulator tab
 Regulierungsschnur
 Regelsnoer
 Elingue (patte)-
 de rglage
 Tensor regulador

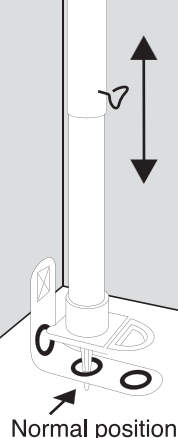

Normal position

4

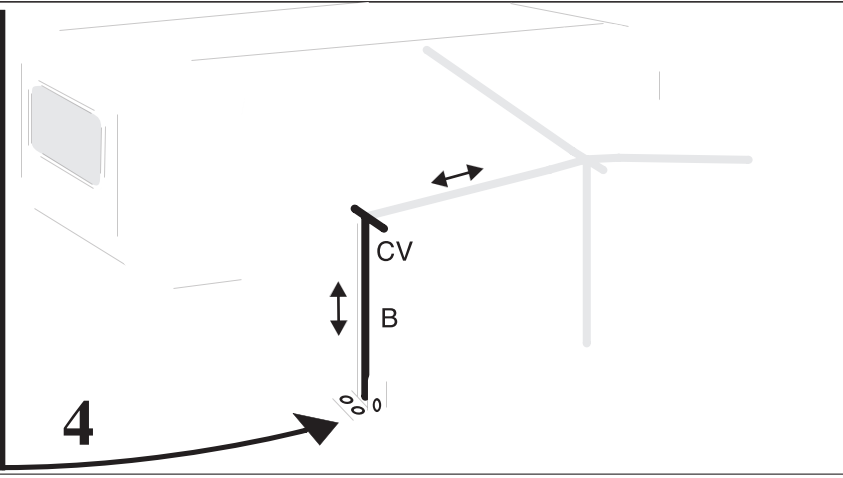

5

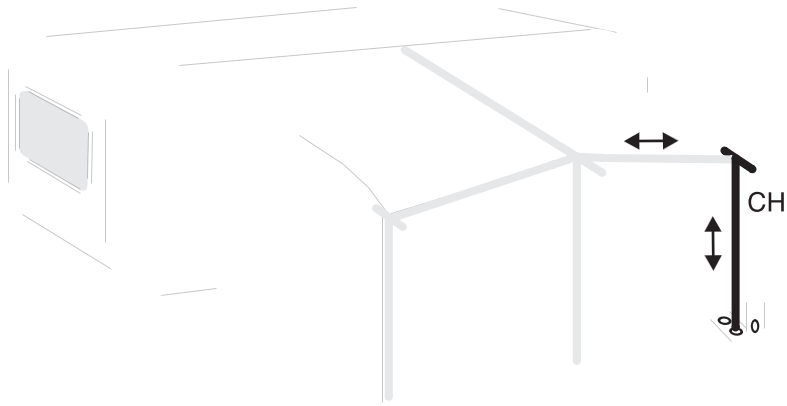

6

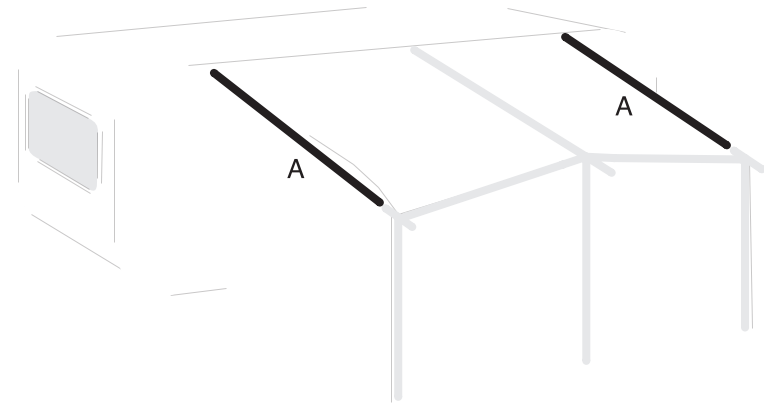

7

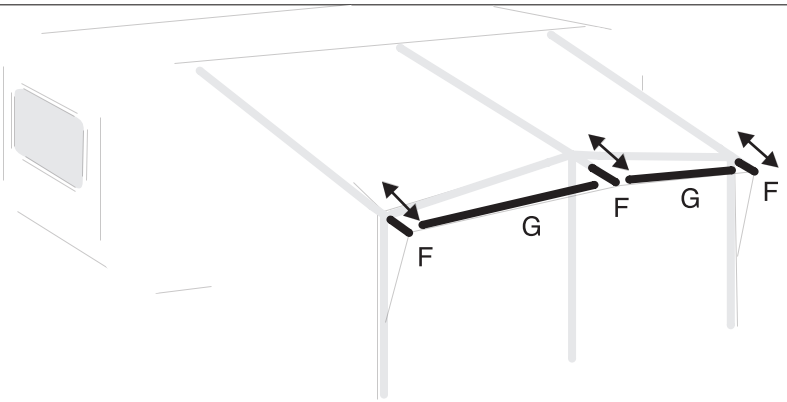

8

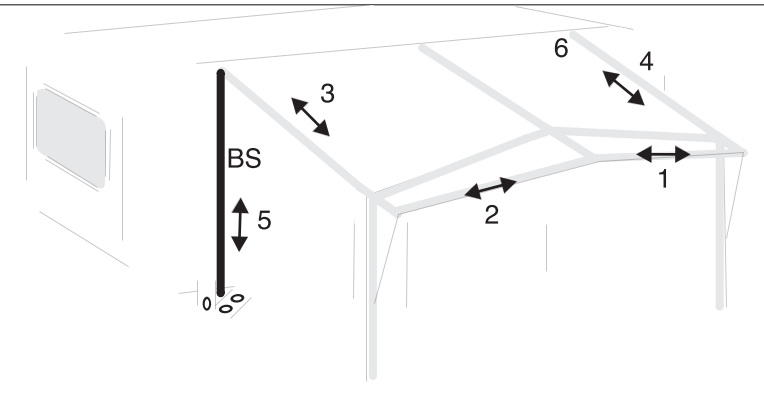

Ekstraudstyr • Optional extra • Sonderausrüstung • Accessoire en option • Accesorio opcional • Arrêt-serrure

FixOn

hvis
if
wenn
wanneer
om
si
quand

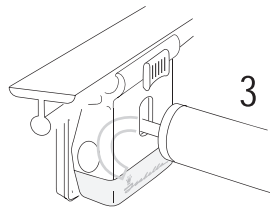
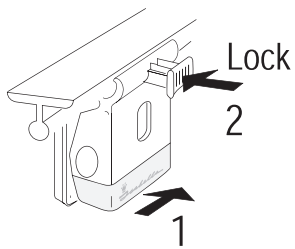

Safe Lock

så
then
dann
dan
entonces

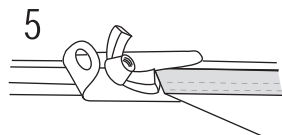
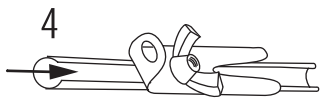

- Skyd Safe Lock i vognens alu-skinne helt op til teltsiden !
- Schieb den Safe Lock in die Alu-Schiene des Wagens bis zur Zeltseite !
- Slide the Safe Lock into the caravan channel up to the awningside !

- 5
- Skub Safe Lock's V-formede slids ind omkring teltvulsten og spænd fast.
- Der Schlitz im Safe Lock über dem Zeltkeder schieben und zuspinnen.
- Push the Safe Lock's V-shape over the beading and tighten it.

9

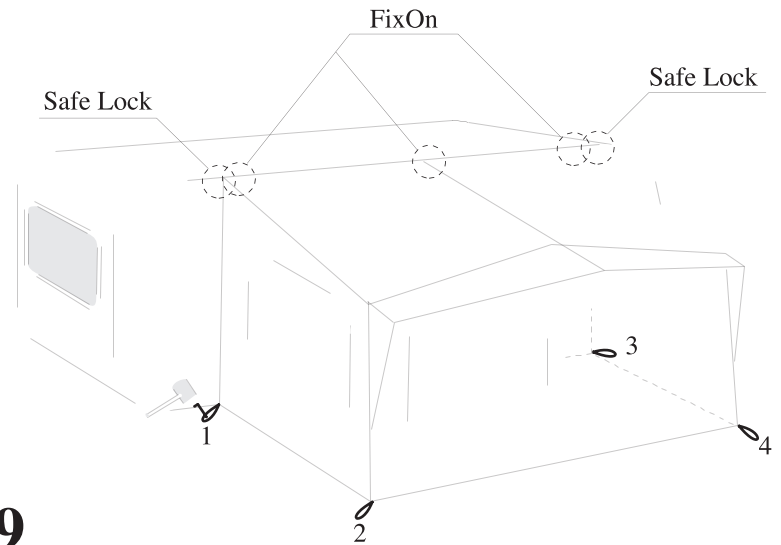

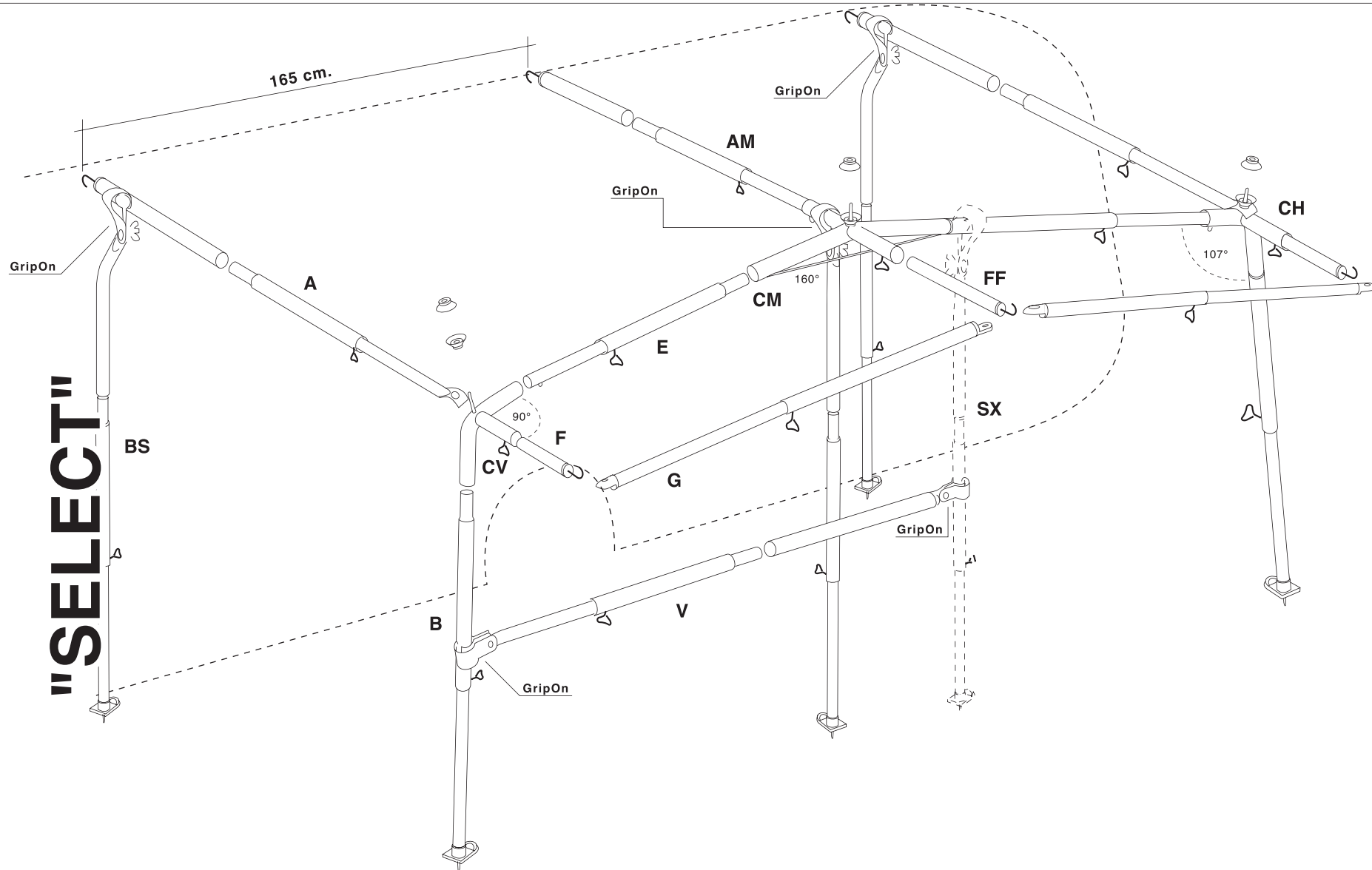

"SELECT"

Isabella
 Steel frame made in Denmark by campion production DK 7100

AKP • Vejle, d. 29/01/98

Zinox

Stål • Metal • Stahl • Staal • Acier • Acero

